

## RACORES BAJA PRESIÓN 150 LBS

Screw low pressure fittings 150 LBS

Raccords basse pression 150 LBS

Raccordi bassa pressione 150 LBS

150 LBS Microfundido ▪ Screwed fittings low pressure 150 LBS ▪ Adapteurs basse pression 150 LBS ▪ Raccordi bassa pressione



150 LBS Soldables ▪ Welding fittings low pressure 150 LBS ▪ Raccords à souder basse pression 150 LBS ▪ Raccordi bassa pressione per saldare 150 LBS



150 LBS Válvulas ▪ 150 LBS fittings Valves ▪ Raccords Vannes 150 LBS ▪ Raccordi Valvole 150LBS

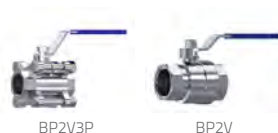

## RACORES BAJA PRESIÓN 150 LBS

Screw low pressure fittings 150 LBS

Raccords basse pression 150 LBS

Raccordi bassa pressione 150 LBS

### Macho fijo espiga FIG.399

Nipple fixed male fig.399

Mâle fixe nipple fig. 399 inox

Maschio fisso fig. 399 inox



ROSCA THREAD	DN	Referencia Part n°	€
1/4"	10	ZFIG39904	3,14
3/8"	12	ZFIG39906	3,70
1/2"	15	ZFIG39908	4,87
3/4"	20	ZFIG39912	7,70
1"	25	ZFIG39916	11,95
1" 1/4	32	ZFIG39920	17,31
1" 1/2	40	ZFIG39924	22,92
2"	52	ZFIG39932	37,58

### Unión macho-macho FIG.150

Union male-male fig.150

Union mâle-mâle fig.150 inox

Unione maschio-maschio fig.150 inox



ROSCA THREAD	Referencia Part n°	€
1/4"	ZFIG15004	2,28
3/8"	ZFIG15006	2,71
1/2"	ZFIG15008	4,07
3/4"	ZFIG15012	5,05
1"	ZFIG15016	6,84
1" 1/4	ZFIG15020	10,96
1" 1/2	ZFIG15024	12,75
2"	ZFIG15032	22,30

### Tapón macho hexagonal FIG.290

Hexagon male plug FIG.290

Bouchon mâle 150 LBS tête hexagonale FIG.290

Tappo maschio esagonale FIG.290



ROSCA THREAD	Referencia Part n°	€
1/8"	ZFIG29002	1,85
1/4"	ZFIG29004	2,16
3/8"	ZFIG29006	2,77
1/2"	ZFIG29008	3,02
3/4"	ZFIG29012	4,87
1"	ZFIG29016	6,96
1" 1/4	ZFIG29020	9,42
1" 1/2	ZFIG29024	12,32
2"	ZFIG29032	19,03
2" 1/2	ZFIG29040	29,88
3"	ZFIG29048	48,11
4"	ZFIG29060	72,20

### Adaptador hexagonal FIG.280

Hexagon nipple FIG.280

Mamelon hexagonal 150 LBS FIG.280

Nipples esagonale FIG.280



ROSCA THREAD	Referencia Part n°	€
1/4"	ZFIG28004	2,16
3/8"	ZFIG28006	2,71
1/2"	ZFIG28008	4,31
3/4"	ZFIG28012	6,22
1"	ZFIG28016	9,61
1" 1/4	ZFIG28020	12,01
1" 1/2	ZFIG28024	16,76
2"	ZFIG28032	28,89
2" 1/2	ZFIG28040	48,29
3"	ZFIG28048	65,11
4"	ZFIG28060	93,32

### Reducción macho-macho FIG.245

Reducer male-male fig. 245

Réduction mâle-mâle fig. 245 inox

Riduzione maschio-maschio fig. 245 inox



THREAD	ROSCA	THREAD	Referencia Part n°	€
1/4"		1/8"	ZFIG2450402	2,16
3/8"		1/4"	ZFIG2450604	2,65
1/2"		1/4"	ZFIG2450804	3,33
1/2"		3/8"	ZFIG2450806	3,45
3/4"		3/8"	ZFIG2451206	4,80
3/4"		1/2"	ZFIG2451208	5,67
1"		1/2"	ZFIG2451608	8,19
1"		3/4"	ZFIG2451612	7,70
1" 1/4		3/4"	ZFIG2452012	9,86
1" 1/4		1"	ZFIG2452016	11,58
1" 1/2		1"	ZFIG2452416	14,11
1" 1/2		1" 1/4	ZFIG2452420	14,11
2"		1" 1/4	ZFIG2453220	19,28
2"		1" 1/2	ZFIG2453224	21,87
2" 1/2		2"	ZFIG2454032	36,28
3"		2" 1/2	ZFIG2454840	57,84

### Tuerca plana FIG.312

Flat nut fig.312

Écrou plat fig.312 inox

Dado piano fig.312 inox



ROSCA THREAD	Referencia Part n°	€
1/4"	ZFIG31204	1,85
3/8"	ZFIG31206	2,03
1/2"	ZFIG31208	2,16
3/4"	ZFIG31212	2,90
1"	ZFIG31216	3,63
1" 1/4	ZFIG31220	5,42
1" 1/2	ZFIG31224	7,33
2"	ZFIG31232	10,90

## RACORES BAJA PRESIÓN 150 LBS

Screw low pressure fittings 150 LBS

Raccords basse pression 150 LBS

Raccordi bassa pressione 150 LBS

### Tapón hembra hexagonal FIG.300

Hexagon female cap. FIG.300

Bouchon femelle hexagonal 150 LBS FIG.300

Tappo femmina esagonale FIG.300



ROSCA THREAD	Referencia Part n°	€
1/8"	ZFIG30002	2,34
1/4"	ZFIG30004	2,71
3/8"	ZFIG30006	2,90
1/2"	ZFIG30008	4,00
3/4"	ZFIG30012	5,73
1"	ZFIG30016	8,19
1"1/4	ZFIG30020	12,07
1"1/2	ZFIG30024	13,43
2"	ZFIG30032	20,02
2"1/2	ZFIG30040	31,11
3"	ZFIG30048	45,34
4"	ZFIG30060	83,16

### Tapón hembra redondo FIG.301

Round female cap. FIG.301

Bouchon femelle ronde 150 LBS FIG.301

Tappo femmina rotondo FIG.301



ROSCA THREAD	Referencia Part n°	€
1/8"	ZFIG30102	2,34
1/4"	ZFIG30104	2,46
3/8"	ZFIG30106	2,46
1/2"	ZFIG30108	3,45
3/4"	ZFIG30112	4,56
1"	ZFIG30116	7,15
1"1/4	ZFIG30120	9,75
1"1/2	ZFIG30124	11,09
2"	ZFIG30132	17,31
2"1/2	ZFIG30140	26,24
3"	ZFIG30148	42,01
4"	ZFIG30160	71,89

Hasta fin de existencias / Until end of stock / Jusqu'à la fin du stock / Fino ad esaurimento

### Adaptador hembra BSP DIN 2986 FIG.270

BSP Female coupling DIN 2986 FIG.270

Manchon femelle gaz DIN 2986 150 LBS FIG.270

Adattatore femmina BSP DIN 2986 FIG.270



ROSCA THREAD	Referencia Part n°	€
1/4"	ZFIG27004	3,14
3/8"	ZFIG27006	3,51
1/2"	ZFIG27008	5,17
3/4"	ZFIG27012	5,05
1"	ZFIG27016	9,73
1"1/4	ZFIG27020	13,18
1"1/2	ZFIG27024	15,28
2"	ZFIG27032	21,38
2"1/2	ZFIG27040	37,08
3"	ZFIG27048	49,83
4"	ZFIG27060	83,28

### Reductor macho-hembra FIG.241

Male-female reducer FIG.241

Réduction 150 LBS MG - FG FIG.241

Riduzione maschio-femmina FIG.241



THREAD	ROSCA THREAD	Referencia Part n°	€
1/8"	1/4"	ZFIG2410204	2,22
1/4"	3/8"	ZFIG2410406	2,34
1/4"	1/2"	ZFIG2410408	3,45
3/8"	1/2"	ZFIG2410608	3,02
1/2"	3/4"	ZFIG2410812	4,50
3/4"	1"	ZFIG2411216	6,90
1"	1"1/4	ZFIG2411620	10,78
1"	1"1/2	ZFIG2411624	14,78
1"1/4	1"1/2	ZFIG2412024	11,46
1"1/2	2"	ZFIG2412432	20,39
2"	2"1/2	ZFIG2413240	35,42
2"1/2	3"	ZFIG2414048	50,76
3"	4"	ZFIG2414860	80,70

### Tapón macho cuadrado FIG.291

Male square plug FIG.291

Bouchon mâle 150 LBS tête carrée FIG.291

Tappo maschio testa quadrata FIG.291



ROSCA THREAD	Referencia Part n°	€
1/8"	ZFIG29102	1,85
1/4"	ZFIG29104	1,97
3/8"	ZFIG29106	2,28
1/2"	ZFIG29108	2,71
3/4"	ZFIG29112	3,94
1"	ZFIG29116	5,54
1"1/4	ZFIG29120	7,95
1"1/2	ZFIG29124	9,67
2"	ZFIG29132	15,52
2"1/2	ZFIG29140	21,50
3"	ZFIG29148	33,51
4"	ZFIG29160	57,41

### Tubo roscado FIG.531

Threaded pipe fig. 531

Tube fileté fig. 531 inox

Tubo filettato fig. 531 inox



ROSCA THREAD	Referencia Part n°	€
1/4"	ZFIG53104	3,33
3/8"	ZFIG53106	3,70
1/2"	ZFIG53108	3,22
3/4"	ZFIG53112	3,83
1"	ZFIG53116	5,68
1"1/4	ZFIG53120	7,53
1"1/2	ZFIG53124	8,69
2"	ZFIG53132	13,49

## RACORES BAJA PRESIÓN 150 LBS

Screw low pressure fittings 150 LBS

Raccords basse pression 150 LBS

Raccordi bassa pressione 150 LBS

### Reducción hembra-hembra FIG.240

Female-female Reducer socket FIG.240

Réduction Femelle-femelle 150 LBS FIG.240

Riduzione femmina-femmina FIG.240



THREAD	ROSCA	THREAD	Referencia Part n°	€
1/4"		1/8"	ZFIG2400402	2,40
3/8"		1/4"	ZFIG2400604	3,14
1/2"		3/8"	ZFIG2400806	4,37
3/4"		1/2"	ZFIG2401208	6,53
1"		3/4"	ZFIG2401612	8,87
1"1/4"		1"	ZFIG2402016	13,31
1"1/2"		1"1/4"	ZFIG2402420	17,37
2"		1"1/2"	ZFIG2403224	19,34
2"1/2"		2"	ZFIG2404032	36,96
3"		2"	ZFIG2404832	53,10
3"		2"1/2"	ZFIG2404840	56,67
4"		2"	ZFIG2406032	69,44

### Codo 90° macho-hembra FIG.092

Male-female elbow 90° FIG.092

Coude 90° 150 LBS MG - FG FIG.092

Adattatore a 90° maschio-femmina FIG.092



ROSCA THREAD	Referencia Part n°	€
1/8"	ZFIG09202	3,02
1/4"	ZFIG09204	3,63
3/8"	ZFIG09206	4,07
1/2"	ZFIG09208	5,79
3/4"	ZFIG09212	8,01
1"	ZFIG09216	12,38
1"1/4"	ZFIG09220	16,26
1"1/2"	ZFIG09224	22,36
2"	ZFIG09232	33,82
2"1/2"	ZFIG09240	64,00
3"	ZFIG09248	107,12
4"	ZFIG09260	195,27

### Codo 90° hembra-hembra FIG.090

Female-female elbow 90° FIG.090

Coude 90° 150 LBS femelle gaz FIG.090

Curva 90° femmina-femmina FIG.090



ROSCA THREAD	Referencia Part n°	€
1/8"	ZFIG09002	2,22
1/4"	ZFIG09004	2,71
3/8"	ZFIG09006	3,51
1/2"	ZFIG09008	4,74
3/4"	ZFIG09012	7,39
1"	ZFIG09016	10,60
1"1/4"	ZFIG09020	15,71
1"1/2"	ZFIG09024	21,50
2"	ZFIG09032	32,77
2"1/2"	ZFIG09040	61,29
3"	ZFIG09048	94,06
4"	ZFIG09060	168,29

### TE hembra-hembra-hembra FIG.130

Female-female TEE FIG.130

TÉS 150 LBS FG - FG - FG FIG.130

Adattatore a T F - F - F



ROSCA THREAD	Referencia Part n°	€
1/8"	ZFIG13002	2,77
1/4"	ZFIG13004	3,67
3/8"	ZFIG13006	4,62
1/2"	ZFIG13008	6,59
3/4"	ZFIG13012	10,04
1"	ZFIG13016	14,23
1"1/4"	ZFIG13020	20,33
1"1/2"	ZFIG13024	27,72
2"	ZFIG13032	42,32
2"1/2"	ZFIG13040	79,40
3"	ZFIG13048	115,87
4"	ZFIG13060	226,63

### Codo 45° hembra-hembra FIG.120

Female-female elbow 45° FIG.120

Coude 45° 150 LBS FG - FG FIG.120

Adattatore a 45° femmina-femmina



ROSCA THREAD	Referencia Part n°	€
1/8"	ZFIG12002	3,02
1/4"	ZFIG12004	3,51
3/8"	ZFIG12006	4,19
1/2"	ZFIG12008	5,54
3/4"	ZFIG12012	8,07
1"	ZFIG12016	10,72
1"1/4"	ZFIG12020	17,19
1"1/2"	ZFIG12024	22,48
2"	ZFIG12032	32,59
2"1/2"	ZFIG12040	55,81
3"	ZFIG12048	83,84
4"	ZFIG12060	146,12

### Cruz roscada FIG.180

Threaded cross FIG.180

Croix égale 150 LBS FG FIG.180

Croce filettata femmina FIG.180



ROSCA THREAD	Referencia Part n°	€
1/8"	ZFIG18002	4,07
1/4"	ZFIG18004	5,54
3/8"	ZFIG18006	6,16
1/2"	ZFIG18008	9,73
3/4"	ZFIG18012	15,40
1"	ZFIG18016	20,27
1"1/4"	ZFIG18020	35,79
1"1/2"	ZFIG18024	37,27
2"	ZFIG18032	55,19
2"1/2"	ZFIG18040	109,40
3"	ZFIG18048	157,76
4"	ZFIG18060	284,16

## RACORES BAJA PRESIÓN 150 LBS

Screw low pressure fittings 150 LBS

Raccords basse pression 150 LBS

Raccordi bassa pressione 150 LBS

### Unión 3 piezas hembra-hembra FIG.340

Female-female FIG.340

Union 3 pièces 150 LBS FG - FG FIG.340

Unione femmina-femmina FIG.340



ROSCA THREAD	Referencia Part n°	€
1/8"	ZFIG34002	7,02
1/4"	ZFIG34004	9,18
3/8"	ZFIG34006	11,33
1/2"	ZFIG34008	12,44
3/4"	ZFIG34012	18,11
1"	ZFIG34016	23,59
1" 1/4	ZFIG34020	35,05
1" 1/2	ZFIG34024	40,53
2"	ZFIG34032	61,05
2" 1/2	ZFIG34040	97,27
3"	ZFIG34048	134,23
4"	ZFIG34060	200,32

### Unión 3 piezas macho-hembra FIG.341

Male-female union FIG.341

Union 3 pièces 150 LBS MG - FG FIG.341

Unione maschio-femmina FIG.341

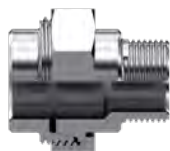

ROSCA THREAD	Referencia Part n°	€
1/4"	ZFIG34104	9,73
3/8"	ZFIG34106	11,83
1/2"	ZFIG34108	13,49
3/4"	ZFIG34112	19,84
1"	ZFIG34116	26,30
1" 1/4	ZFIG34120	38,81
1" 1/2	ZFIG34124	46,08
2"	ZFIG34132	70,04
2" 1/2	ZFIG34140	106,57
3"	ZFIG34148	144,14
4"	ZFIG34160	226,56

### Macho soldar FIG.149

Welding male fig.149

Mâle à souder fig.149 inox

Maschio a saldare fig. 149 inox



ROSCA THREAD	Referencia Part n°	€
1/4"	ZFIG14904	1,79
3/8"	ZFIG14906	2,09
1/2"	ZFIG14908	2,65
3/4"	ZFIG14912	3,57
1"	ZFIG14916	4,87
1" 1/4	ZFIG14920	7,27
1" 1/2	ZFIG14924	8,38
2"	ZFIG14932	11,77

### Unión 3 piezas hembra-soldar FIG.340HS microfundido

Union 3 fem. welding pieces fig.340hs micro-casting

Union 3 pcs fem. à souder fig.340hs acier moulé

Unione a 3 pezzi f.saldare fig.340hs microfusione



ROSCA THREAD	Referencia Part n°	€
1/4"	ZFIG34004HS	9,24
3/8"	ZFIG34006HS	11,03
1/2"	ZFIG34008HS	13,41
3/4"	ZFIG34012HS	17,80
1"	ZFIG34016HS	24,21
1" 1/4	ZFIG34020HS	35,05
1" 1/2	ZFIG34024HS	40,53
2"	ZFIG34032HS	61,91

### Unión 3 piezas soldar FIG.340S microfundido

Union 3 welding pieces fig. 340s micro-casting

Union 3 pièces à souder fig. 340s acier moulé

Unione a 3 pezzi a saldare fig.340s microfusione



DN	Referencia Part n°	€
1/4"	ZFIG34004S	9,06
3/8"	ZFIG34006S	10,78
1/2"	ZFIG34008S	13,49
3/4"	ZFIG34012S	16,63
1"	ZFIG34016S	22,55
1" 1/4	ZFIG34020S	32,09
1" 1/2	ZFIG34024S	36,59
2"	ZFIG34032S	57,16

### Unión 3 piezas macho-soldar FIG.341MS microfundido

Union 3 welding male pieces fig.341ms micro-casting

Union 3 pcs mâle à souder fig.341ms acier moulé

Unione a 3 pezzi m.saldare fig.341ms microfusione



ROSCA THREAD	Referencia Part n°	€
1/4"	ZFIG34104MS	9,92
3/8"	ZFIG34106MS	11,09
1/2"	ZFIG34108MS	14,04
3/4"	ZFIG34112MS	20,45
1"	ZFIG34116MS	27,04
1" 1/4	ZFIG34120MS	38,81
1" 1/2	ZFIG34124MS	46,08
2"	ZFIG34132MS	71,15

## RACORES BAJA PRESIÓN 150 LBS

Screw low pressure fittings 150 LBS

Raccords basse pression 150 LBS

Raccordi bassa pressione 150 LBS

### Válvula esfera paso total baja presión 3 piezas

Ball-valve low pressure full bore 3 pcs

Robinet basse pression 2 voies boisseau sphérique passage total 3 pcs

Rubinetto a sfera bassa pressione 3 pcs



### Válvula esfera paso total baja presión 64 Bar

Ball-valve low pressure full bore 64 Bar

Robinet basse pression 2 voies boisseau sphérique passage total 64 Bar

Rubinetto a sfera bassa pressione passaggio totale 64 Bar



ROSCA THREAD	Referencia Part n°	€
1/4" BSP	BP2V3P14INOX	30,22
3/8" BSP	BP2V3P38INOX	30,22
1/2" BSP	BP2V3P12INOX	38,34
3/4" BSP	BP2V3P34INOX	47,67
1" BSP	BP2V3P1INOX	65,31
1" 1/4 BSP	BP2V3P114INOX	108,38
1" 1/2 BSP	BP2V3P112INOX	138,06
2" BSP	BP2V3P2INOX	194,11

ROSCA THREAD	DN	Referencia Part n°	€
1/4" BSP	8	BP2V14INOX	19,00
3/8" BSP	10	BP2V38INOX	19,00
1/2" BSP	15	BP2V12INOX	21,57
3/4" BSP	20	BP2V34INOX	29,95
1" BSP	25	BP2V1INOX	69,64
1"1/4 BSP	32	BP2V114INOX	63,64
1"1/2 BSP	40	BP2V112INOX	97,09
2" BSP	50	BP2V2INOX	151,72
2"1/2 BSP	65	BP2V212INOX	302,15
3" BSP	80	BP2V3INOX	440,49

FLUIDAL